

AIR DRILL INSPECTION TOOL





FOR JOHN DEERE 90 SERIES + PROSERIES NO-TILL DRILLS

OVERVIEW:

The Red E Air Drill Inspection Tool is a multitool designed to allow you to inspect various critical components on your John Deere 90 series and ProSeries no-till drills. Worn out parts can have a strong impact on seed placement and affect the health of your crop. [#keeponfarming](https://www.instagram.com/keeponfarming) and stay up to date with high quality and effective parts.

DESIGN CHARACTERISTICS:

IT CAN MEASURE...

-  Disc wear
-  Seed tab wear
-  Boot slop
-  Boot profile wear

Tools Required:

-  Just the Inspection tool!

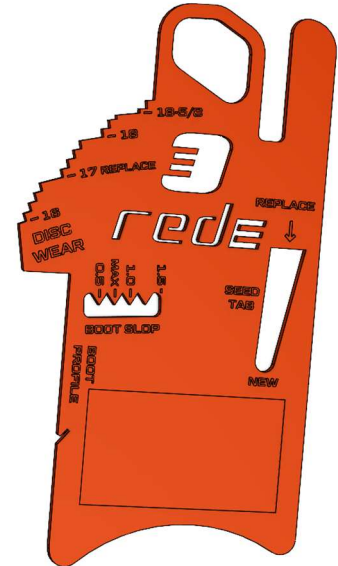

INSPECTION INSTRUCTIONS:

DISC LIFE

Slide tool in along disc so that curved bottom rests on the disc hub. The disc diameter can be read using the stepped edge of the inspection tool. Increments are given in 1/4 inch. Disc should be replaced at 17" diameter or when edge is dull.

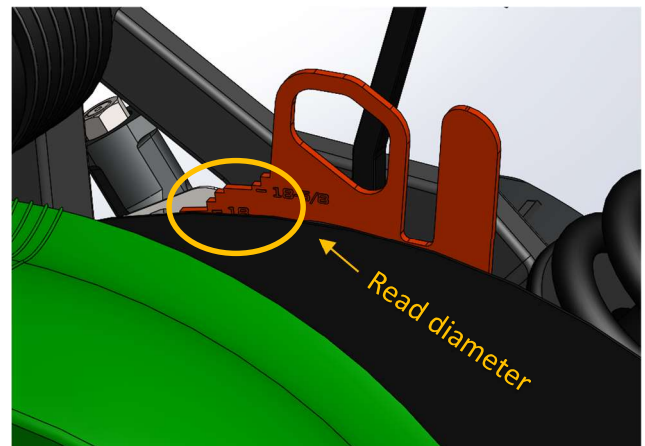
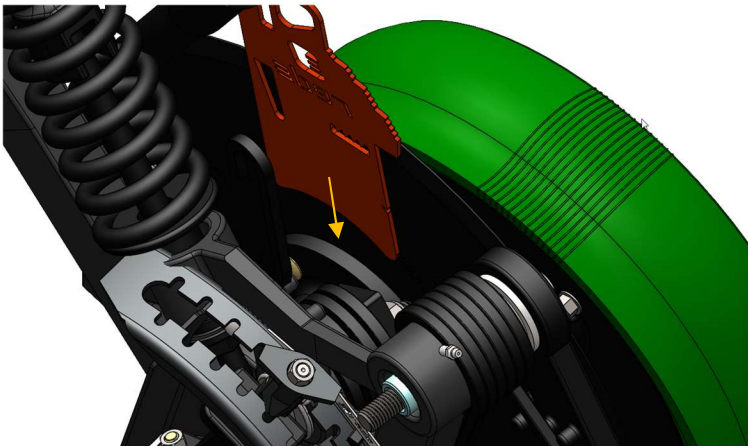

SEED TAB LIFE

To measure seed tab, slide tongue between seed boot and disc under press wheel. If little to no tab is visible in the cutout, it should be replaced.

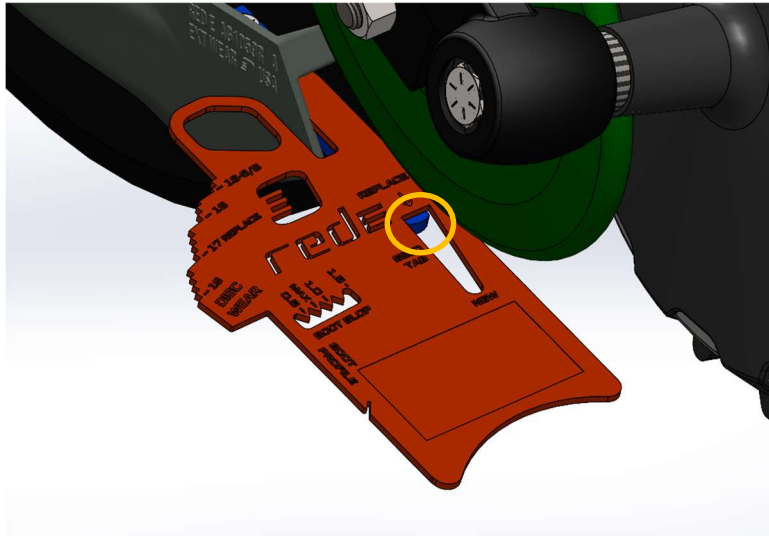

SEED BOOT SLOP

Rest curved bottom against hub and press down onto top of boot with the edge of the inspection tool. Hold the inspection tool in place while wiggling boot to its farthest extremes. There should be 1/2" or less of vertical play.

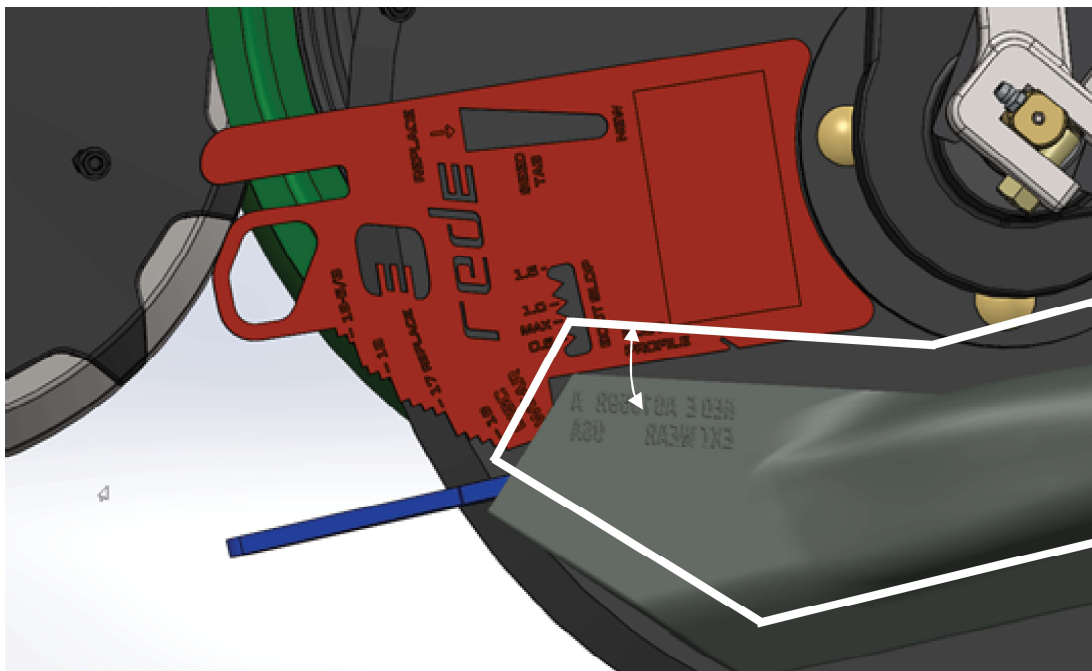

AIR DRILL INSPECTION TOOL

FOR JOHN DEERE 90 SERIES + PROSERIES NO-TILL DRILLS

SEED BOOT WEAR

Place tool as shown on bottom edge of boot to inspect profile wear. If the bottom edge isn't straight across, it's time to replace the seed boot. (Usually, the back tip wears down first)

